

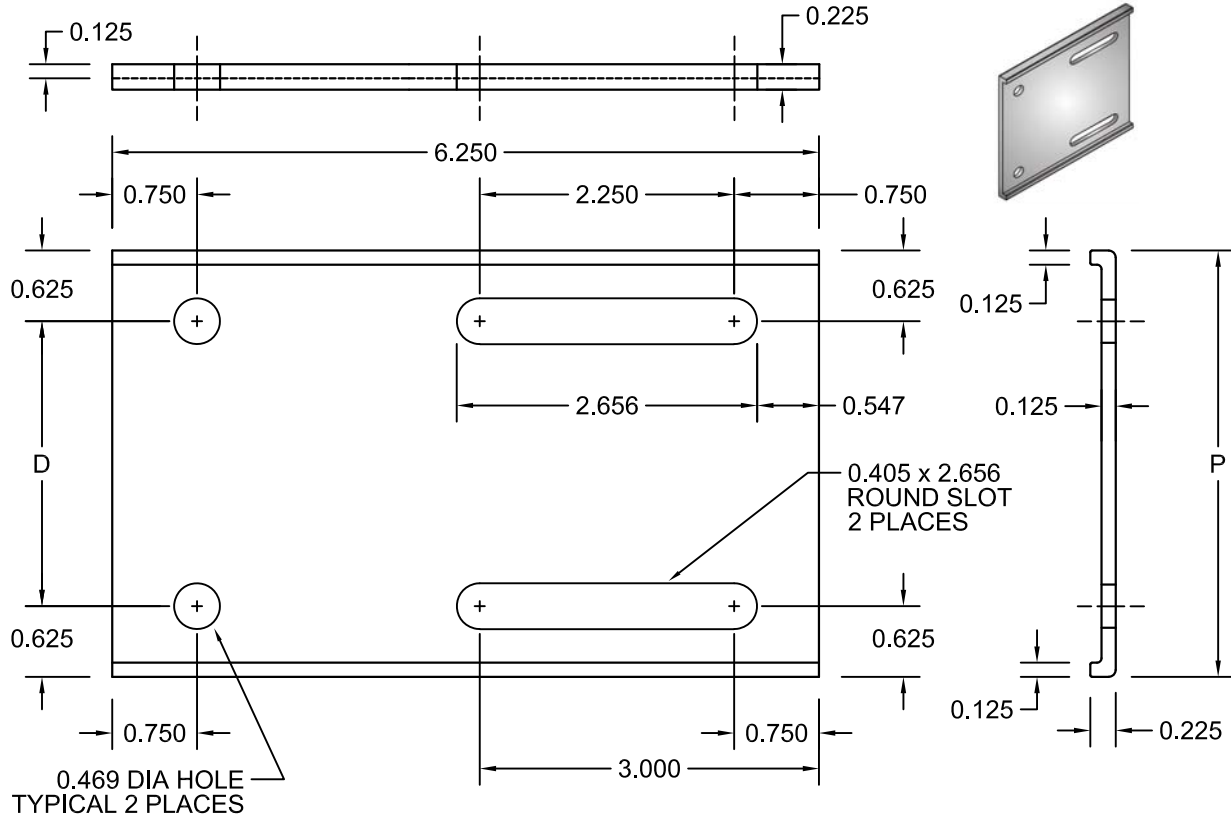

NO.	REVISION	BY	DATE	MATERIAL I.D.
0	APPROVED	WW	04-18-17	SPE



TRAY SIDE RAIL HEIGHT		CATALOG NUMBER	P	D	EXTRUSION PROFILE	PLATE QTY.	‡
H* (NOMINAL)	ACTUAL						
4	4.25"	SPE-A4-S4	3.87"	2.62"	EXT-SP-604	2	
5	5.25"	SPE-A5-S4	4.87"	3.62"	EXT-SP-605	2	
6	6.25"	SPE-A6-S4	5.87"	4.62"	EXT-SP-606	2	
7	7.25"	SPE-A7-S4	6.87"	5.62"	EXT-SP-607	2	

‡ MARK "√" IN BOX TO INCLUDE IN SUBMITTAL

F*	FASTENER MATERIAL	INCLUDED FASTENERS	FASTENER CATALOG NO.	QTY.	‡
S	TYPE 316 STAINLESS STEEL	3/8" x 3/4" RIBBED-NECK SCREW	F-RNS-38-34-S	4	
		3/8" FLANGED HEX NUT	F-FHN-38-S	4	
		3/8" x 3/4" MACHINE SCREW	F-PRS-38-34-S	4	
		3/8" LOCKING HEX NUT	F-LHN-38-S	4	
		3/8" FLAT ROUND WASHER	F-FRW-38-S	4	

**NOTES:**

1. COMPLETE ASSEMBLY CONSISTS OF (2) PLATES WITH FASTENERS INDICATED.
2. RIBBED-NECK SCREWS AND FLANGED HEX NUTS ARE TO BE INSTALLED IN THE ROUND HOLES. MACHINE SCREWS, LOCKING HEX NUTS AND ROUND WASHERS ARE TO BE INSTALLED IN THE SLOTS.

INSTALLATION: INSTALL IN ACCORDANCE WITH NEMA STD. PUBLICATION VE-2 "CABLE TRAY INSTALLATION GUIDELINES".

<p>CABLE TRAYS EMPLOYING THESE CONNECTORS DO REQUIRE THE USE OF BONDING JUMPERS IN ORDER TO MAINTAIN THE GROUND PATH INTEGRITY OF THE CABLE TRAY SYSTEM. (UL FILE NO. E341872)</p>	<b>ATKORE</b> 560 WHARTON CIRCLE, SUITE E    PHONE: 404-696-8585 ATLANTA, GA 30336 USA        FAX: 404-696-8599		SHEET NO. <b>1 OF 1</b>
	DIMENSIONS <b>INCHES</b>		
<b>DESCRIPTION</b> EXPANSION SPLICE PLATES - CLASS 1 & 2 TRAYS			
<b>CATALOG NUMBER</b> <b>SPE-A(H*)-S4</b>		<b>CATALOG NUMBER VARIABLES</b> H* = NOMINAL TRAY SIDE RAIL HEIGHT IN INCHES (4, 5, 6, 7)	
<b>MATERIAL:</b> EXTRUDED ALUMINUM 6063-T6			
NOTE: ALL DIMENSIONS ARE SUBJECT TO THE MANUFACTURING TOLERANCE SPECIFICATIONS IN DOCUMENT USP-QA-05-02.			