

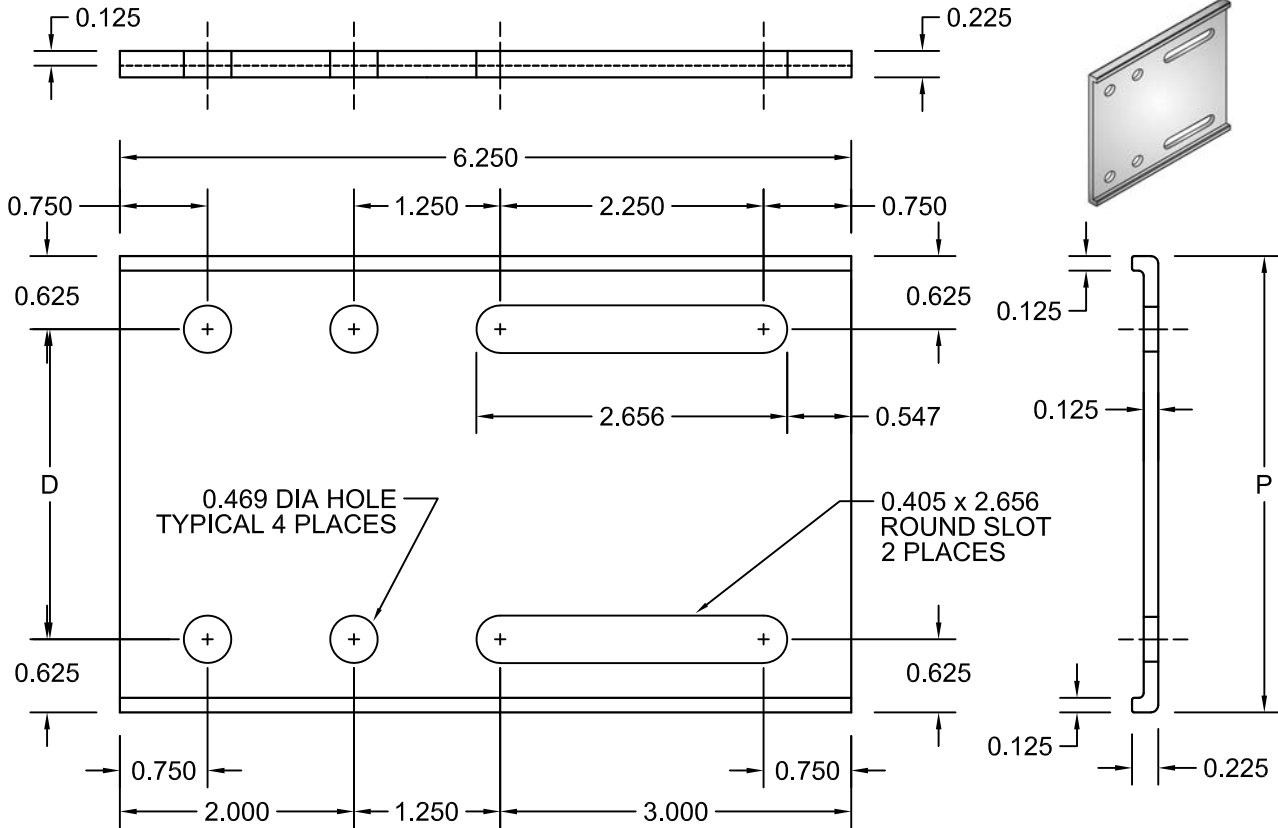

NO.	REVISION	BY	DATE	MATERIAL I.D.
0	APPROVED	WW	04-18-17	SPE
1	ADDED U.L. INFO, REV. LAYOUT	KD	12-06-17	



TRAY SIDE RAIL HEIGHT		CATALOG NUMBER	P	D	EXTRUSION PROFILE	PLATE QTY.	‡
H* (NOMINAL)	ACTUAL						
4	4.25"	SPE-A4-S8	3.87"	2.62"	EXT-SP-604	2	
5	5.25"	SPE-A5-S8	4.87"	3.62"	EXT-SP-605	2	
6	6.25"	SPE-A6-S8	5.87"	4.62"	EXT-SP-606	2	
7	7.25"	SPE-A7-S8	6.87"	5.62"	EXT-SP-607	2	

‡ MARK "√" IN BOX TO INCLUDE IN SUBMITTAL

F*	FASTENER MATERIAL	INCLUDED FASTENERS	FASTENER CATALOG NO.	QTY.
S	TYPE 316 STAINLESS STEEL	3/8" x 3/4" RIBBED-NECK SCREW	F-RNS-38-34-S	8
		3/8" FLANGED HEX NUT	F-FHN-38-S	8
		3/8" x 3/4" MACHINE SCREW	F-PRS-38-34-S	8
		3/8" LOCKING HEX NUT	F-LHN-38-S	8
		3/8" FLAT ROUND WASHER	F-FRW-38-S	8

INSTALLATION: INSTALL IN ACCORDANCE WITH NEMA STD. PUBLICATION VE-2 "CABLE TRAY INSTALLATION GUIDELINES".

NOTES:

- COMPLETE ASSEMBLY CONSISTS OF (2) PLATES WITH FASTENERS INDICATED.
- RIBBED-NECK SCREWS AND FLANGED HEX NUTS ARE TO BE INSTALLED IN THE ROUND HOLES. MACHINE SCREWS, LOCKING HEX NUTS AND ROUND WASHERS ARE TO BE INSTALLED IN THE SLOTS.



CABLE TRAYS EMPLOYING THESE CONNECTORS DO REQUIRE THE USE OF BONDING JUMPERS IN ORDER TO MAINTAIN THE GROUND PATH INTEGRITY OF THE CABLE TRAY SYSTEM. (UL FILE NO. E341872)

MATERIAL: EXTRUDED ALUMINUM 6063-T6

NOTE: ALL DIMENSIONS ARE SUBJECT TO THE MANUFACTURING TOLERANCE SPECIFICATIONS IN DOCUMENT USP-QA-05-02.

ATKORE

560 WHARTON CIRCLE, SUITE E PHONE: 404-696-8585
ATLANTA, GA 30336 USA FAX: 404-696-8599

SHEET NO.
1 OF 1

DIMENSIONS
INCHES

DESCRIPTION

EXPANSION SPLICE PLATES - 8 SCREWS

CATALOG NUMBER

SPE-A(H*)-S8

CATALOG NUMBER VARIABLES

H* = NOMINAL TRAY SIDE RAIL HEIGHT IN INCHES (4, 5, 6, 7)