

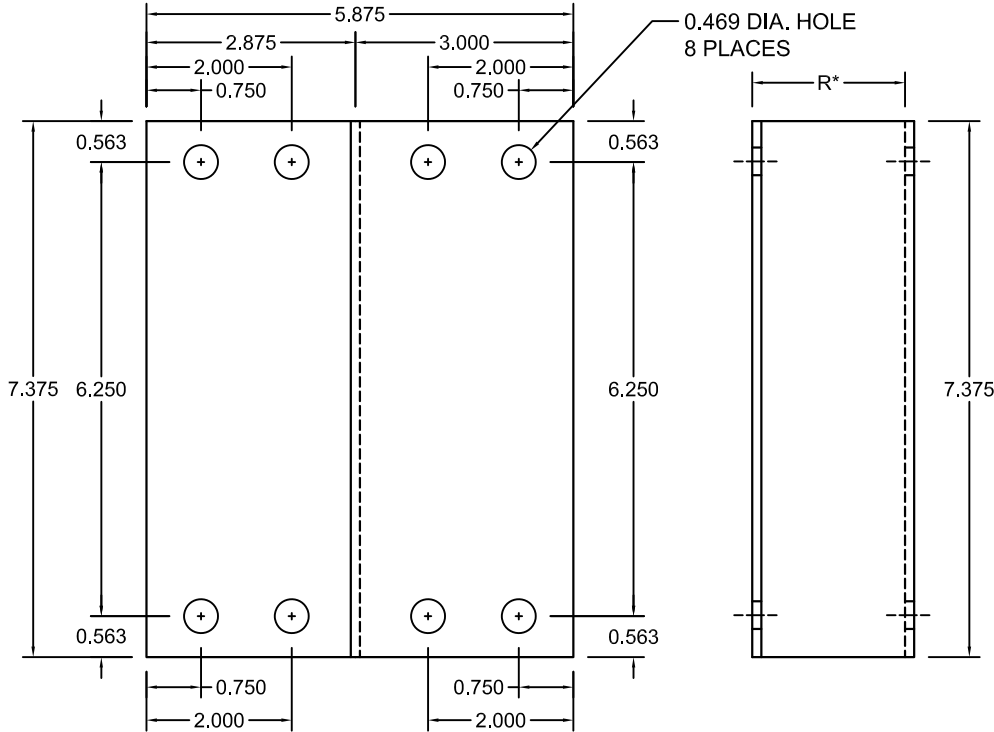

NO.	REVISION	BY	DATE	MATERIAL I.D.
0	APPROVED	TM	07-01-15	SPR-A8

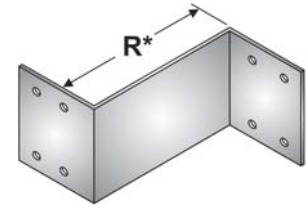
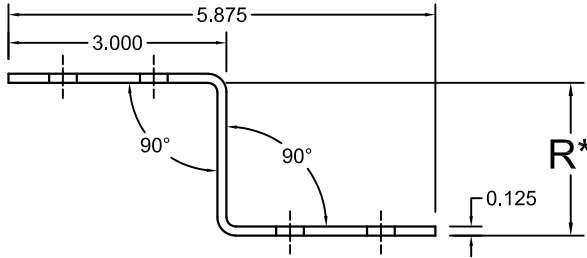

‡	R* WIDTH REDUCTION	
	1.5	1.5"
	03	3"
	4.5	4.5"
	06	6.5"
	7.5	7.5"
	09	9"
	10.5	10.5"
	12	12"
	13.5	13.5"
	15	15"
	18	18"
	21	21"
	24	24"
	27	27"
	30	30"

NOTES:

1. COMPLETE ASSEMBLY CONSISTS OF (2) PLATES WITH FASTENERS INDICATED.
2. THESE PLATES ARE USED TO JOIN CABLE TRAYS HAVING DIFFERENT WIDTHS. FOR A COMPLETE TRAY COUPLING INSTALL THIS PLATE ON ONE TRAY SIDE RAIL AND ANOTHER REDUCING PLATE OR STRAIGHT SPLICE PLATE (BOTH SUPPLIED SEPARATELY) ON THE OTHER SIDE RAIL.
3. INSTALL IN ACCORDANCE WITH NEMA STANDARD VE-2 CABLE TRAY INSTALLATION GUIDELINES.
4. THESE PLATES ARE DESIGNED FOR USE WITH CLASS 4 CABLE TRAY SYSTEM A820E.

‡	F*	FASTENER MATERIAL	INCLUDED FASTENERS	FASTENER CATALOG NO.	QTY.
	G	GEOMET-PLATED STEEL	3/8" x 3/4" RIBBED-NECK SCREW	F-RNS-38-34-G	16
			3/8" FLANGED HEX NUT	F-FHN-38-G	16
	S	TYPE 316 STAINLESS STEEL	3/8" x 3/4" RIBBED-NECK SCREW	F-RNS-38-34-S	16
			3/8" FLANGED HEX NUT	F-FHN-38-S	16

‡ MARK "√" IN BOX TO INCLUDE IN SUBMITTAL

CLASSIFIED

 UL FILE E341872
 CABLE TRAYS EMPLOYING THESE CONNECTORS ARE CLASSIFIED BY UNDERWRITERS LABORATORIES TO BE SUITABLE FOR USE AS EQUIPMENT GROUNDING CONDUCTORS. BONDING JUMPERS ARE NOT REQUIRED TO MAINTAIN GROUND PATH INTEGRITY. RESISTANCE ACROSS COUPLING IS LESS THAN 0.00033 OHMS. CERTIFIED BY U.L. TO MEET NEC. 392 AND NEMA STD. VE1, CSA-C22.2 NO. 126.1.

MATERIAL: ALUMINUM ALLOY 5052

NOTE: ALL DIMENSIONS ARE SUBJECT TO THE MANUFACTURING TOLERANCE SPECIFICATIONS IN DOCUMENT USP-QA-05-02.

ATKORE
 560 WHARTON CIRCLE, SUITE E PHONE: 404-696-8585
 ATLANTA, GA 30336 USA FAX: 404-696-8599

SHEET NO.
 1 OF 1
 DIMENSIONS
 INCHES

DESCRIPTION
 REDUCING SPLICE PLATES - 8" HIGH, CLASS 4 TRAYS

CATALOG NUMBER
 SPR-(R*)-A8-(F*)8

CATALOG NUMBER VARIABLES
 F* = FASTENER MATERIAL (G OR S)
 R* = WIDTH REDUCTION IN INCHES (SEE CHART ABOVE)