

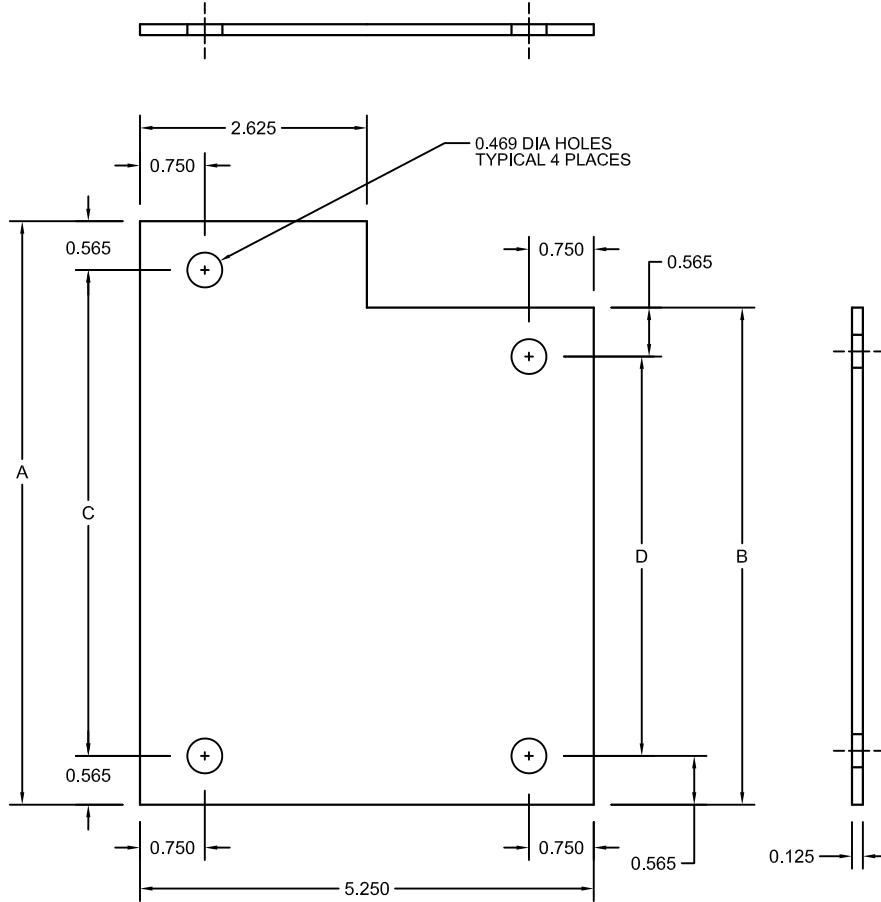

NO.	REVISION	BY	DATE	MATERIAL I.D.
0	APPROVED	TM	12-12-13	SPD
1	ADDED U.L. INFO, REV. LAYOUT, ADDED CHART	KD	12-05-17	



F*	FASTENER MATERIAL	INCLUDED FASTENERS	FASTENER CATALOG NO.	QTY.	‡
G	GEOMET-PLATED STEEL	3/8" x 3/4" RIBBED-NECK SCREW	F-RNS-38-34-G	8	
		3/8" FLANGED HEX NUT	F-FHN-38-G	8	
S	TYPE 316 STAINLESS STEEL	3/8" x 3/4" RIBBED-NECK SCREW	F-RNS-38-34-S	8	
		3/8" FLANGED HEX NUT	F-FHN-38-S	8	

‡ MARK "√" IN BOX TO INCLUDE IN SUBMITTAL

‡	CATALOG NUMBER	TRAY SIDE RAIL HEIGHT		A	B	C	D
		H1	H2				
	SPD-A76-(F*)4	7	6	6.87	5.87	5.62	4.62
	SPD-A75-(F*)4	7	5	6.87	4.87	5.62	3.62
	SPD-A74-(F*)4	7	4	6.87	3.87	5.62	2.62
	SPD-A65-(F*)4	6	5	5.87	4.87	4.62	3.62
	SPD-A64-(F*)4	6	4	5.87	3.87	4.62	2.62
	SPD-A54-(F*)4	5	4	4.87	3.87	3.62	2.62

NOTES:

1. COMPLETE ASSEMBLY CONSISTS OF (2) PLATES WITH FASTENERS INDICATED.
2. THIS CONNECTOR IS DESIGNED TO CONNECT TRAYS WITH DIFFERENT SIDE RAIL HEIGHTS.

CLASSIFIED

 UL FILE E341872

CABLE TRAYS EMPLOYING THESE CONNECTORS ARE CLASSIFIED BY UNDERWRITERS LABORATORIES TO BE SUITABLE FOR USE AS EQUIPMENT GROUNDING CONDUCTORS. BONDING JUMPERS ARE NOT REQUIRED TO MAINTAIN GROUND PATH INTEGRITY. RESISTANCE ACROSS COUPLING IS LESS THAN 0.00033 OHMS. CERTIFIED BY U.L. TO MEET NEC. 392 AND NEMA STD. VE1, CSA-C22.2 NO. 126.1.

MATERIAL: ALUMINUM ALLOY 5052-H32

NOTE: ALL DIMENSIONS ARE SUBJECT TO THE MANUFACTURING TOLERANCE SPECIFICATIONS IN DOCUMENT USP-QA-05-02.

ATKORE

560 WHARTON CIRCLE, SUITE E ATLANTA, GA 30336 USA
 PHONE: 404-696-8585 FAX: 404-696-8599

SHEET NO.
 1 OF 1
 DIMENSIONS
 INCHES

DESCRIPTION

STEP DOWN CONNECTOR - 4 HOLES

CATALOG NUMBER

SPD-A(H1*)(H2*)-(F*)4

CATALOG NUMBER VARIABLES

F* = FASTENER MATERIAL (G OR S)
 H1* = TRAY 1 SIDE RAIL HEIGHT
 H2* = TRAY 2 SIDE RAIL HEIGHT